

2000441-400X Current Transmitter



- ✓ Convert high-current industrial signals into standard analog signals
- ✓ 0-400A Input
- ✓ 40-60 Hz Frequency Range
- ✓ 4-20mA Linear Output
- ✓ Basic Accuracy $\pm 0.2\%$ FS
- ✓ Response Time: $\leq 10\text{ms}$ (0-90%)
- ✓ 22 mm Aperture
- ✓ R250 4-20mA Current Loop Shunt Resistor Included
- ✓ CE Compliance

Introduction

2000441 series current transmitter adopts the Hall Principle to directly convert the high- current signal from the industrial field into the standard analog signal, and the input and output signals are linear. The input, output, and power supply are reliably isolated from each other.

Features

- 22mm aperture
- 0-400A Input
- 4-20mA Output

Specifications

- Frequency range: 40-60Hz
- Output signal: 4-20mA
- Power: DC12V/24V/220V, AC220V
- Rated power consumption: ≤ 1 W (power supply DC24V, output 20mA)
- Basic Accuracy: $\leq 0.2\%$ F.S.
- Temperature Drift: 0.2% F.S./ $^{\circ}\text{C}$ ($-30^{\circ}\text{C} \sim +85^{\circ}\text{C}$)
- Response Time: $\leq 10\text{ms}$ (0-90%) (TYP)
- Insulation Strength: 3000V AC/1min (input, output, and power)
- Working Temperature: $-30^{\circ}\text{C} \sim +85^{\circ}\text{C}$
- 4-20mA Current Loop Shunt Resistor Included
- EMC: CE Compliance

Compatible with all DATAQ Instruments Hardware Products. Popular products include:

- DI-2108: <https://www.dataq.com/products/di-2108/>
- DI-2108-P: <https://dataq.com/products/di-2108-p/>
- DI-4108: <https://www.dataq.com/products/di-4108-e/>
- DI-4208: <https://www.dataq.com/products/di-4208-e/>
- DI-4718B (with 8B modules): <https://www.dataq.com/products/di-4718b/>
- DIN-P24 Power Supply must be purchased separately

Dimensions

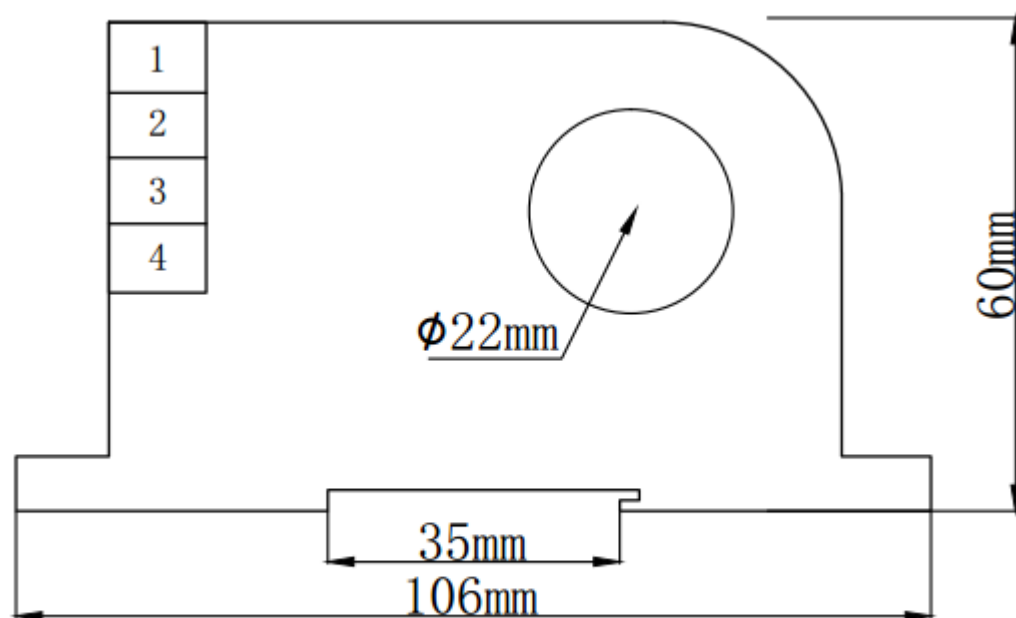

Wiring

